

YOUR NAME _____

Start the trail at the grey arrow
Follow the numbers from 1-12.

1 Font

This is where people are baptised (or christened) when they become members of the church.

What is put in the font during baptism/christening?

W _____

How many sides does the font have? _____

Who presented it to the church in 1890? (stand in the aisle and look down low)



2 Picton Memorial Window

Fill the missing words: "Suffer the

to come unto me"

Who is the window in memory of?



3 Pulpit

The pulpit is used for giving talks about God.

How many steps does it have? _____

Why is it so high? _____



4 Altar

The altar is a table; it is where the priest or vicar leads worship. Look at the cloth covering the front of the altar? The cloth is called a frontal.

What colour is it today? _____

In the space below, draw just one thing that you can see in the picture on the cloth.

5 East Window

The Archangel Michael is shown in the bottom left hand corner of the window.

What is he wearing?

How can you tell that he is an angel?

What animal is he resting his sword on?

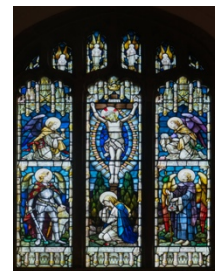

6 Lady Chapel Window

How many angels can you see? _____

The angel in the bottom right hand side of the window is holding a roundel with a man and woman in it, who do you think they are? A _____ and E _____

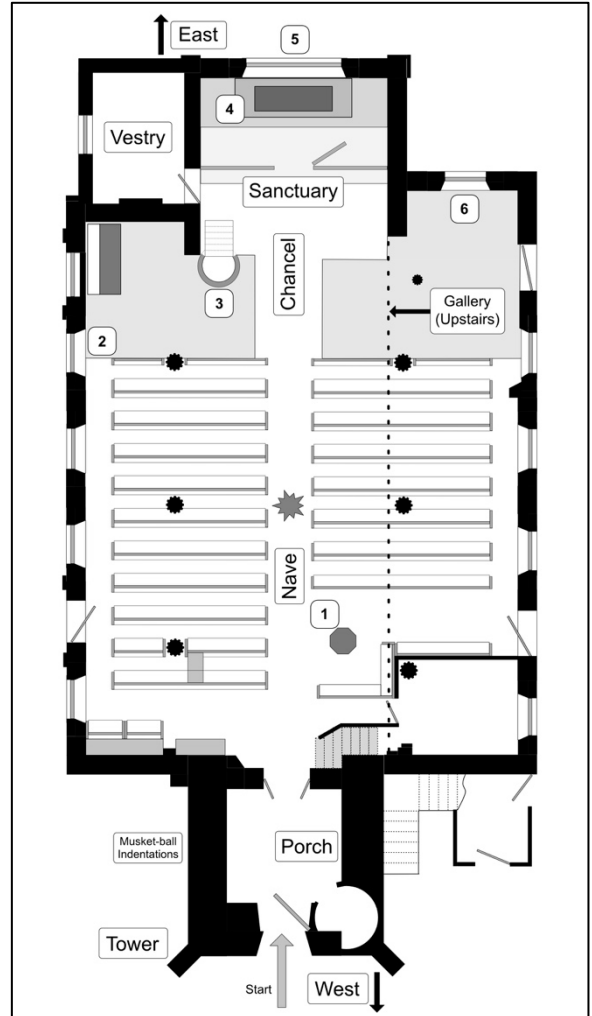

7 Gallery (Children must always be accompanied by an adult)

To access the gallery, go up the stairs near the font.

Look for the monogram shown to the right carved into the woodwork underneath the windows. A monogram is a symbol for a name or initials.



Can you work out what the letters are? _____

Draw a monogram of your own initials in the space below:

8 Roof of the Nave

Stand by the font and look up.

What do you think the roof is made of?

Draw one of the roof patterns you can see in the space below:

9 Chandelier

The chandelier (which is made of brass) hangs from the roof, stand by the font and look up.

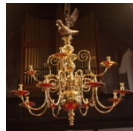

How many candle holders can you count on the chandelier? _____

What can you see perched on the top of the chandelier? _____

What do you think it represents? p ___ c ___

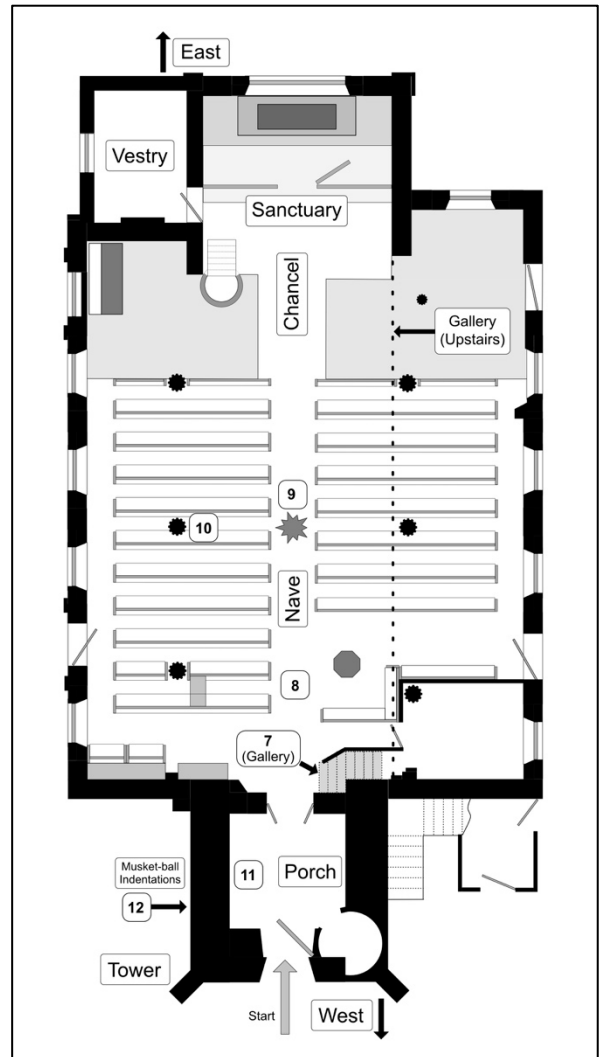

10 Sunday School Banner

How many animals can you see on this banner? _____

Find the Cheshire cat, caterpillar and butterfly on the banner, and draw one of them in the space below.

Write the names of other animals that you can see.



11 Porch

Look high up on the walls. Where do you think the vicar used to put his horse's saddle when he arrived at the church?

Why do you think he came to church on a horse?

12 Musket-ball Indentations

On your way out of the church's main (west) door after completing the trail, turn right into the churchyard. Do not go onto the road!

Look on the north-facing wall of the sandstone church tower, about 1.5 metres above the ground. Can you see the musket-ball indentations?

How many can you count? We make it between 20 and 25.