

Conversation pieces for a memory-friendly trail

INTRODUCTION

By 1300 a chapel with links to an Augustinian Priory became the Parish Church of Plympton St Maurice dedicated to St Thomas of Canterbury (Thomas a Becket). In 1538 the dedication was changed to St Maurice who was a Roman Legion Commander who had been martyred for refusing to make sacrifice to the gods.

The church was for some time known as St Thomas and St Maurice. In the 14th and 15th centuries it was reconstructed in the Perpendicular style of the period; the most notable feature of the new church was a tall tower. Various alterations were made over the years and during the incumbency of the Revd H.T. Hole, who was Rector for 44 years (1877-1921), a complete restoration of the Church was carried out.

1 DOOR



Take a moment to look at the door.

What do you notice about it?

Run your hands

over it and describe what it feels like.

Put your hand on the latch and open it. Is it warm or cold?

Give the door a push and open it. Would you say it opens smoothly, is it heavy or light to push?

EAST

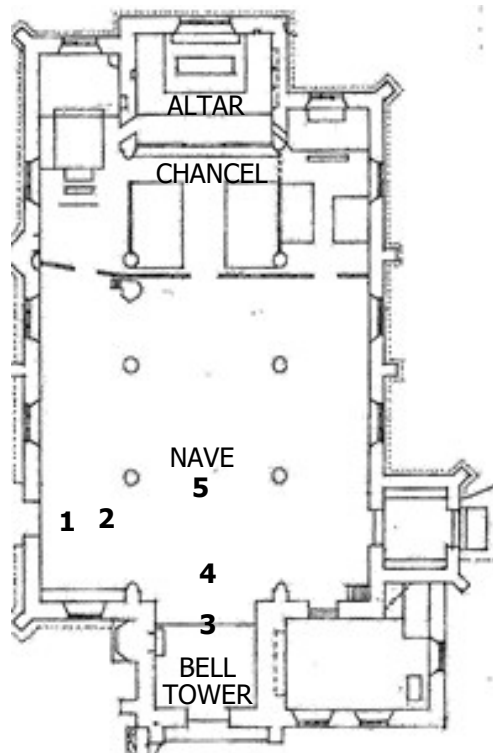

WEST

2 FIRST IMPRESSIONS



Stand here for a moment and take a deep breath through your nose.

Hold it for a couple of seconds and then breath out.

What do you notice?

Are there any smells or sensations that come to mind, for example is it cold, damp, musty, can you smell flowers?

3 THE FONT

Spend a few minutes here and share what you notice. For example what is it made of, does it have carvings, is it very worn and old?



Talk about what would happen here and any thoughts on who would do what.

Do you have memories of family Christenings?

5 THE NAVE



Let's walk down the Aisle and stop half way to have a look around.

First of all look up, what do you see in the roof? For example, rafters, angels, carved bosses.

Then take a look to your right and then your left and tell us what you see.

4 THE TOWER



What do you notice here?

For example the Bell Ropes. Look up— do you have any stories to share about what happens when these ropes are pulled?

Consider what it would be like in here when the bells are ringing. Are there events in your life when you had bells rung for you?

6 THE ORGAN



Have you ever played an organ or any other musical instrument?

Do you have any favourite pieces of music that you remember being played on an organ?

Were you ever in a church choir and do you remember any of the hymns that you sang?

EAST

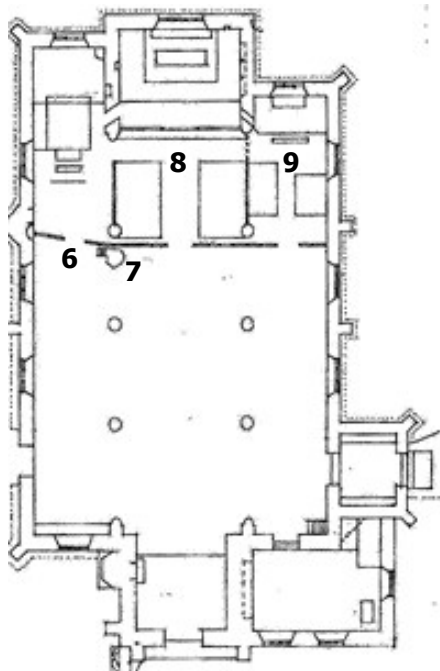

7 THE PULPIT

Share your thoughts on who would use this and what they would do from here.



Touch the Pulpit — what is it made of and what does it feel like?

Can you see carvings and what are they of?

Do you remember sitting and listening to very long talks from the person standing in a Pulpit?

8 THE ALTAR



Looking around what catches your eye, for example the cloth on the Altar, Cross, candles?

What happens here, for example the Communion?

Who would lead this service?

What would they be wearing and what would they be using, for example a chalice?

9 CHAPEL OF ST MAURICE

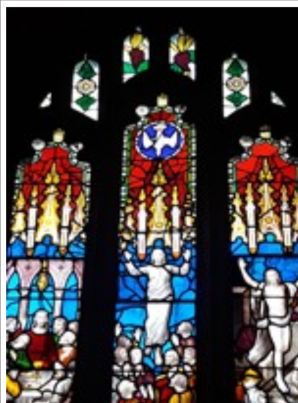

Look up at the window behind the Altar. What thoughts come to mind?

What colours can you see?

Do the figures remind you of a story?

What sort of glass is this?

Which is your favourite part of this window?

10 DRAWING

Draw a picture of the best thing you have seen on your visit today