

CHILDREN'S GARDEN TRAIL

Follow the numbers 1-12 on this map to answer the questions.

Take care – after 600 years the paths and steps are a little uneven!

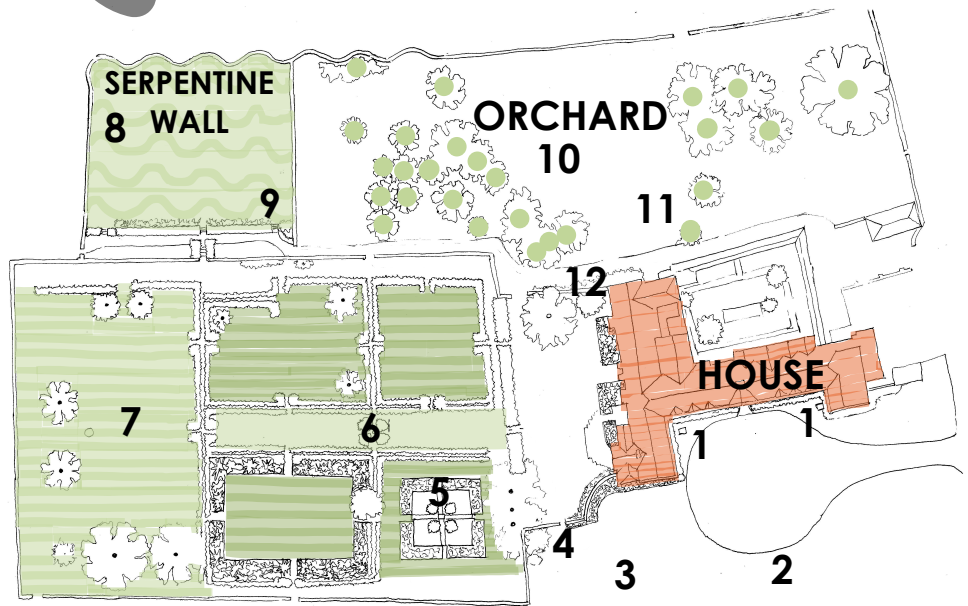

1 LITTLE BRICK HOUSES

What do you think these two small houses were used for?

.....
The bowls in front might give you a clue. One of them is round and the other is an _ _ _ _ G O N



2 HOUSE WINDOWS

Stand in front of the house at number 2 on the map. How many windows can you count?

3 BUILDING MATERIALS

West Horsley Place has been added to over the centuries, and many different materials have been used. Tick the boxes when you spot any of them as you walk the grounds:

BRICK LEAD STONE TILE PEBBLE WOOD GLASS

4 WROUGHT IRON GATES

There are many beautiful examples of this type of gate around the grounds. Which craftsman makes items from wrought iron?

IRONMONGER

BLACKSMITH FORGER



5 ROSE GARDEN

Unscramble the letters to find the name of this tall structure in the rose garden

V E O C T D E O

.....



6 PET BIRD EPITAPH

What was the name of the pet bird remembered here?

When did the bird live?
19__ until 19__



7 LOWER LAWN

Can you guess what game used to be played on this large lawn?

Cricket

Tennis



Croquet

8 SERPENTINE WALL

Why do you think this wall is called 'serpentine'?

.....
Can you guess the other name for this type of wall?

CURLY WHIRLY TOPSY TURVEY

ZIGGY ZAGGY CRINKLE CRANKLE



9 MYSTERY OBJECT

You can find this object in the same area as the serpentine wall. Mark the place with an X. What do you think it is?

W _ _ _ _ P _ _ _



10 ORCHARD

Which fruit tree is not growing in the orchard?

MULBERRY

PLUM

PEAR

ORANGE

DAMSON

APPLE



11 ORCHARD SCULPTURES

These lovely sculptures of Don Quixote and Sancho Panza have been made from lots of objects that would otherwise have been thrown away. They are all made of

PLASTIC

WOOD

METAL



Name three of the objects used:

.....

12 MATHEMATICAL TILES

Stand at 12 and look at the top section of bricks.

Are they the normal size or is there something odd about them? Look carefully at the edge!

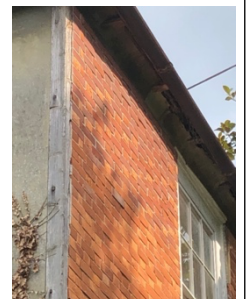

.....